

## Screen Elements

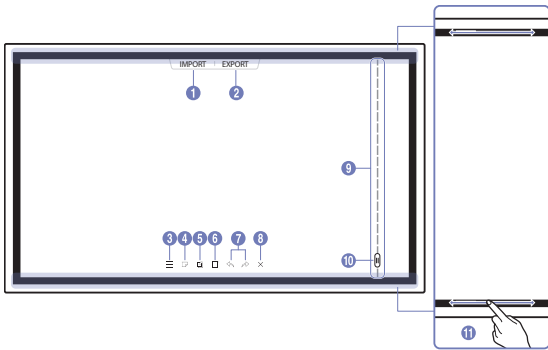

Buttons	Description
1 <b>IMPORT</b>	View the screen of a mobile device or PC connected to the product, or import data such as images from a connected USB or network drive.
2 <b>EXPORT</b>	Share your creations in various ways.
3	Manage and change the rolls and settings.
4	Move or edit the created rolls for each page.
5	Create a layer to write or draw on over the screen which can also be saved the captured image.
6	Select and edit / capture / email / print the pen or brush content.
7	Undo or redo the last action. <ul style="list-style-type: none"> <li>If any page editing actions such as page adding, deleting, and moving are found,  is reset.</li> <li>*  can be performed up to 20 times for each individual.</li> </ul>
8	Close the current roll and create a new roll.
9 Page breaking line	See page lines.
10	Scroll through pages.
11 Bezel Scroll	Scroll the black area to move the pages.

## Drawing

You can freely use the supplied pen to write anything you want.

- Thin Tip (A): Pen Type
- Thick Tip (B): Highlighter Type

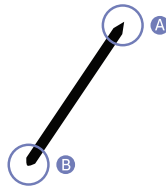

## Changing the pen thickness and color

You can change the pen color by touching and holding the screen with the pen.

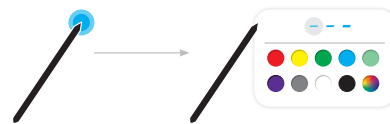

## Erasing

You can use your finger or palm to erase your writing.

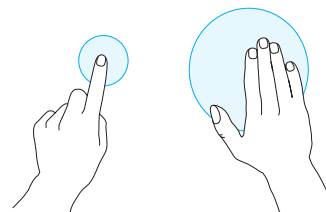

## Managing Rolls

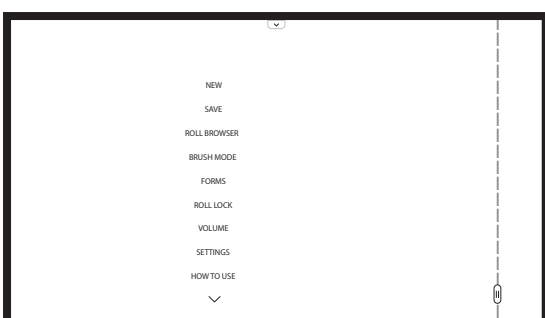
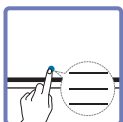

Buttons	Description
<b>NEW</b>	Create a new roll.
<b>SAVE</b>	Save the current roll.
<b>ROLL BROWSER</b>	Open, delete or export saved rolls.
<b>PEN MODE / BRUSH MODE</b>	Choose a mode.
<b>FORMS</b>	Change the background format. <ul style="list-style-type: none"> <li>* This menu is only visible in <b>PEN MODE</b> mode.</li> </ul>
<b>ROLL LOCK / UNLOCK</b>	<ul style="list-style-type: none"> <li><b>ROLL LOCK</b> : Press a six-digit password to lock the current roll.</li> <li><b>UNLOCK</b> : To unlock a locked roll, press the six-digit password you set when locking the roll.</li> <li>* Once unlocked, the current roll remains unlocked until it is locked again.</li> </ul>
<b>VOLUME</b>	Adjust the volume.
<b>SETTINGS</b>	You can see the configuration menu.
<b>HOW TO USE</b>	You can view How To Use.

## Import content from devices or internet

You can view the screen of a mobile device or PC connected to the product, or import data such as images from a connected USB or network drive.

- Touch **IMPORT** at the top of the screen to select the desired device.

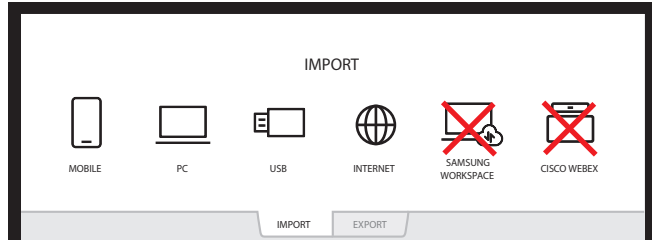

Icons	Description
	Displays the screen from a mobile device by using Smart View or Screen Mirroring function.
	Displays your PC screen imported using HDMI, DP (Supported models: WM85R), OPS (Supported models: WM85R) connection or Wireless Display.
	Import videos, images, native FLIP files, or document files from a USB device.
	Connect the network to access the Internet from the product like accessing the Internet from a computer.
	Access to remote PC and your work resources with this function.
	When you connect CISCO WebEx Room Kit Mini for the first time, select <b>IMPORT PC HDMI</b> to generate the icon. When you tap the icon, it is switched to CISCO WebEx mode.

" The native FLIP format (.iwb) refers to files that are directly saved from the device and only supported by FLIP devices.

" Supported video file formats: avi, mkv, asf, wmv, .mp4, mov, 3gp, vro, mpg, mpeg, ts, tp, trp, flv, vob, svi, m2ts, mts, .webm, .rmvb

" Supportable image file formats: JPG, BMP, PNG, MPO

" Supported document file formats: DOC, PPT, PDF, XLS, XLSX

## How to connect to the Samsung Flip

directly from your Microsoft computer or Android mobile phone



## Source Window

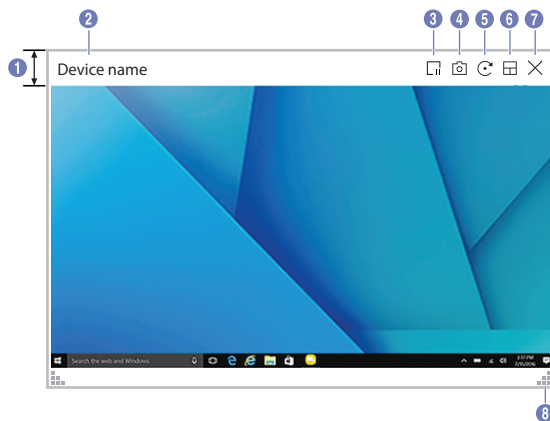

\* Available functions may differ depending on the PIP setting.

When you connect a PC or a mobile device to the product, the source window appears.

Parts	Description
1 Menu bar	Drag the source window to move to the desired position.
2 Device name	Displays the name of the connected device.
3	Pause the input screen display.
4	Capture the source window. " This feature is not available when <b>PIP Capture</b> is set to <b>Off</b> .
5	Rotate the source window. " This function is supported only on Android 8.0 Oreo version or later of Samsung mobile devices.
6	Change the input screen position or view it on full screen. • " When the product is in portrait orientation, the full screen mode is supported only on the Android 8.0 Oreo version or later of Samsung mobile devices. " The icon images are for position reference only. The size of the screen may differ from what is shown.
7	Close the viewer.
8	Adjust the size of the source window.

## Export content to devices

You can export your created rolls in various ways.

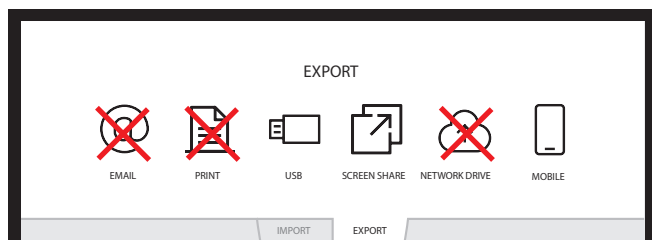

Icons	Description
	Send your created rolls via email.
	Print your created rolls.
	Export your created rolls to a connected USB device.
	Share your screen with selected devices.
	Export your created rolls to a registered and connected network drive.
	Send the roll to a mobile device.